

Shrink Fit Holder

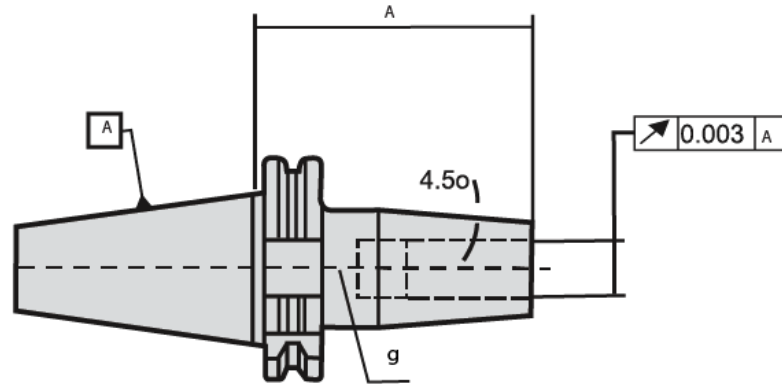

Balanced for G6.3 @ 8,000 rpm

Taper Size	Specification	d	A	Kg
BT 40	SFH-SK40-06-100	6	100	1.3
	SFH-SK40-08-100	8	100	1.3
	SFH-SK40-10-100	10	100	1.4
	SFH-SK40-12-100	12	100	1.4
	SFH-SK40-14-100	14	100	1.5
	SFH-SK40-16-100	16	100	1.5
	SFH-SK40-18-100	18	100	1.7
	SFH-SK40-20-100	20	100	1.7
	SFH-SK40-25-100	25	100	1.7
BT 50	SFH-SK50-08-120	8	120	3.8
	SFH-SK50-10-120	10	120	3.8
	SFH-SK50-12-120	12	120	3.9
	SFH-SK50-14-120	14	120	3.9
	SFH-SK50-16-120	16	120	4.0
	SFH-SK50-18-120	18	120	4.0
	SFH-SK50-20-120	20	120	4.1
	SFH-SK50-25-120	25	120	4.1
	SFH-SK50-32-120	32	120	4.3

• Special Sizes offered on request

Spare Parts & Accessories



Pull Stud
Page No. 22