

# Morse Taper Holder with Tang DIN 6383

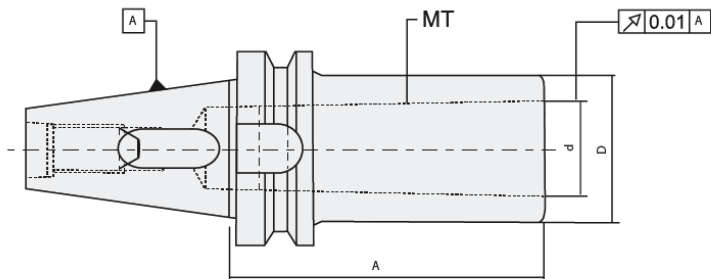

Balanced for G6.3 @ 8,000 rpm

| Taper Size       | Specification    | d   | A   | Kg  |
|------------------|------------------|-----|-----|-----|
| BT 30            | MTH-BT30-MT1-050 | MT1 | 50  | 0.4 |
|                  | MTH-BT30-MT2-063 | MT2 | 63  | 0.5 |
|                  | MTH-BT30-MT3-070 | MT3 | 70  | 0.7 |
| BT 40            | MTH-BT40-MT1-050 | MT1 | 50  | 1   |
|                  | MTH-BT40-MT1-063 | MT1 | 63  | 1.3 |
|                  | MTH-BT40-MT1-100 | MT1 | 100 | 1.5 |
|                  | MTH-BT40-MT2-050 | MT2 | 50  | 1.1 |
|                  | MTH-BT40-MT2-063 | MT2 | 63  | 1.2 |
|                  | MTH-BT40-MT2-100 | MT2 | 100 | 1.3 |
|                  | MTH-BT40-MT3-063 | MT3 | 63  | 1.1 |
|                  | MTH-BT40-MT3-100 | MT3 | 100 | 1.3 |
|                  | MTH-BT40-MT3-120 | MT3 | 120 | 1.4 |
| BT 50            | MTH-BT40-MT4-100 | MT4 | 100 | 1.3 |
|                  | MTH-BT50-MT1-050 | MT1 | 50  | 3.5 |
|                  | MTH-BT50-MT1-063 | MT1 | 63  | 3.6 |
|                  | MTH-BT50-MT1-100 | MT1 | 100 | 3.9 |
|                  | MTH-BT50-MT2-050 | MT2 | 50  | 3.5 |
|                  | MTH-BT50-MT2-063 | MT2 | 63  | 3.6 |
|                  | MTH-BT50-MT2-100 | MT2 | 100 | 3.9 |
|                  | MTH-BT50-MT3-063 | MT3 | 63  | 3.5 |
|                  | MTH-BT40-MT3-100 | MT3 | 100 |     |
|                  | MTH-BT40-MT3-120 | MT3 | 120 |     |
| MTH-BT50-MT4-100 | MT4              | 100 | 3.6 |     |
| MTH-BT50-MT5-120 | MT5              | 120 | 3.9 |     |

• Special GPL Holders offered on request

Spare Parts & Accessories

